

ILLUMINATED PUSH BUTTON

GBL

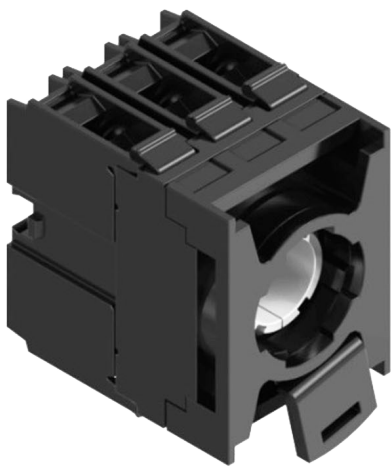



sermat^{GRÜN}**ex**

REV.20 / 18.06.2019

ILLUMINATED PUSH BUTTON

Technical Data

TECHNICAL SPECIFICATION

TYPE OF PROTECTION	Ex "d" – Flameproof Ex "tb" – Dust ignition protection	Explosion proof Dust ignition proof	Ex "d" – Flameproof Ex "tb" – Dust ignition protection
MARKING	Ex d IIC Gb Ex tb IIIC Db	Class I, Groups B, C, D Class II, Groups E, F, G Class III	II 2 G Ex db IIC / IIB +H ₂ Gb II 2 D Ex tb IIIC Db
AREA OF APPLICATION	Zone 1 Zone 2 Zone 21 Zone 22	Class I, Div 1 & 2, Groups B, C, D. Class II, Div 1 & 2, Groups E, F, G. Class III	Zone 1 Zone 2 Zone 21 Zone 22
INGRESS PROTECTION	IP66W (W: 200h salt spray)	Type 4X	IP66W (W: 200h salt spray)
TEMPERATURE RANGE	-50°C to 60°C (-40°F to 158°F)	-50°C to 60°C (-40°F to 158°F)	-50°C to 60°C (-40°F to 158°F)
THREAD SIZE	M22 x 1,5 3/4" NPSM	M22 x 1,5 3/4" NPSM	M22 x 1,5 3/4" NPSM
THREAD LENGTH	25mm (Normal) 40mm (Long) 57mm (Extra Long)	25mm (Normal) 40mm (Long) 57mm (Extra Long)	25mm (Normal) 40mm (Long) 57mm (Extra Long)
INSTALLATION	for M22x1,5 THREAD in Ex "d"enclosures : (min. wall thickness : 8 mm engaged thread) in Ex "tb" enclosures : (min. wall thickness : 3 mm engaged thread)	for M22x1,5 THREAD in Ex "d"enclosures : (min. 6 fully engaged threads) in Ex "tb" enclosures : (min. 3 fully engaged threads)	for M22x1,5 THREAD in Ex "d"enclosures : (min. wall thickness : 8 mm engaged thread) in Ex "tb" enclosures : (min. wall thickness : 3 mm engaged thread)t
	for 3/4"NPSM THREAD in Ex "d"enclosures : (min. 5 fully engaged threads) in Ex "tb" enclosures : (min. wall thickness : 3,7 mm engaged thread)	for 3/4"NPSM THREAD in Ex "d"enclosures : (min. 7 fully engaged threads) in Ex "tb" enclosures : (min. 3 fully engaged threads)	for 3/4"NPSM THREAD in Ex "d"enclosures : (min. 5 fully engaged threads) in Ex "tb" enclosures : (min. wall thickness : 3,7 mm engaged thread)
CERTIFICATE OF COMPLIANCE	Segurança  INMETRO CEPEL 97.0007U	 UL UL: E489210	 ATEX I IECEx Sira 16ATEX1176U IECEx CSA 16.0032U

ILLUMINATED PUSH BUTTON

Technical Data

ELECTRICAL SPECIFICATION

CONTACT BLOCKS INFORMATION		
RATED VOLTAGE	Ui 500V	
RATED CURRENT	Ith 6A	
CONTACTS FOR AC 15	VOLTAGE	CURRENT
	250V	6A
CONTACTS FOR DC 13	VOLTAGE	CURRENT
	24Vdc	3A

PILOT LIGHT HOUSING	
MAXIMUM POWER	2,6W
MAXIMUM VOLTAGE	250V

LED INFORMATION	
UTILITY LIFE	> 50.000 hours
RATED CORRENT	12mA
MAXIMUM POWER	1,5W

DIMENSIONS

X	
mm	inch
25mm	≈ 1"
40mm	≈ 1.19/32"
57mm	≈ 2.1/4"

M22 X 1,5

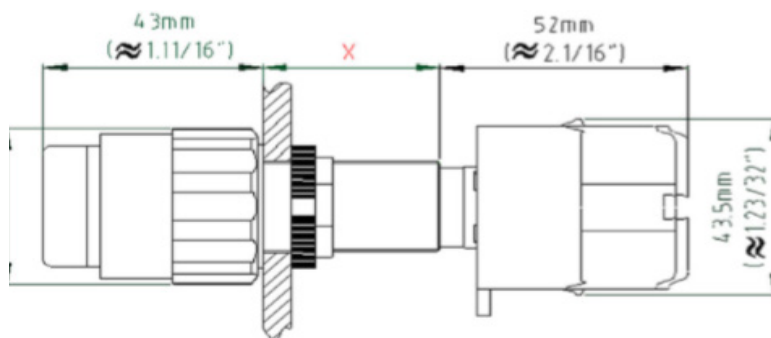

3/4"NPSM

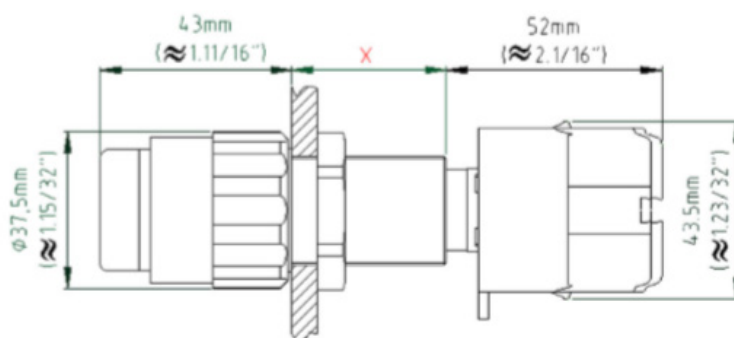

ILLUMINATED PUSH BUTTON

Ordering Code

ORDERING CODE

SGEXXGBL A + B + C + D

X

THREAD SIZE

size	M22x1,5	3/4"NPSM
code	22	26

A

THREAD LENGTH

length	25mm	40mm	57mm
code	N	L	X

B

COLOR



color	Blue	Yellow	Red	Green	White
code	AZ	AM	VM	VD	BR

C

CONTACT BLOCK



	NO	NC	NONC	2NO	2NC
code	10	01	11	20	02



D

LED

LED COLOR

COLOR	BLUE	YELLOW	RED	GREEN	WHITE
CODE	AZ	AM	VM	VD	BR

LED VOLTAGE

VOLTAGE	12 VAC/VDC	24 VAC/VDC	120 VAC/VDC	240 VAC	480 VAC
CODE	01	02	03	.	.

SPECIAL CONFIGURATIONS
ONLY FOR PILOT LIGHT









NOTE: The LEDs can be sold separately.
For more LED ordering code information, please require APPENDIX - L LED Ordering Code

ILLUMINATED PUSH BUTTON

Codification Examples
& Accessories

CODIFICATION EXAMPLES

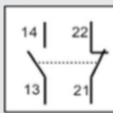
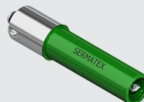
	+	3/4NPSM LENGTH 25MM	+		+		+		=	SGEX26GBLNV0104
SGEX26GBL		N		VM		01		VM04 220V		
	+	M22X1,5 LENGTH 25MM	+		+		+		=	SGEX22GBLNV1104
SGEX22GBL		N		VD		11		VD04 220V		

ACCESSORIES

IDENTIFICATION PLATE (for M22x1,5 or 3/4 NPSM thread)



CODE	S3PL1		
PRINTABLE AREA	32x19 mm		
G00	LIGA	G05	STOP
G01	DESLIGA	G06	RESET
G02	ABRE	G07	OPEN
G03	FECHA	G08	CLOSE
G04	START	G09	

DIMENSIONS (mm)

