

CIRCUIT BREAKER ACTUATOR

ADJUSTABLE
GADA

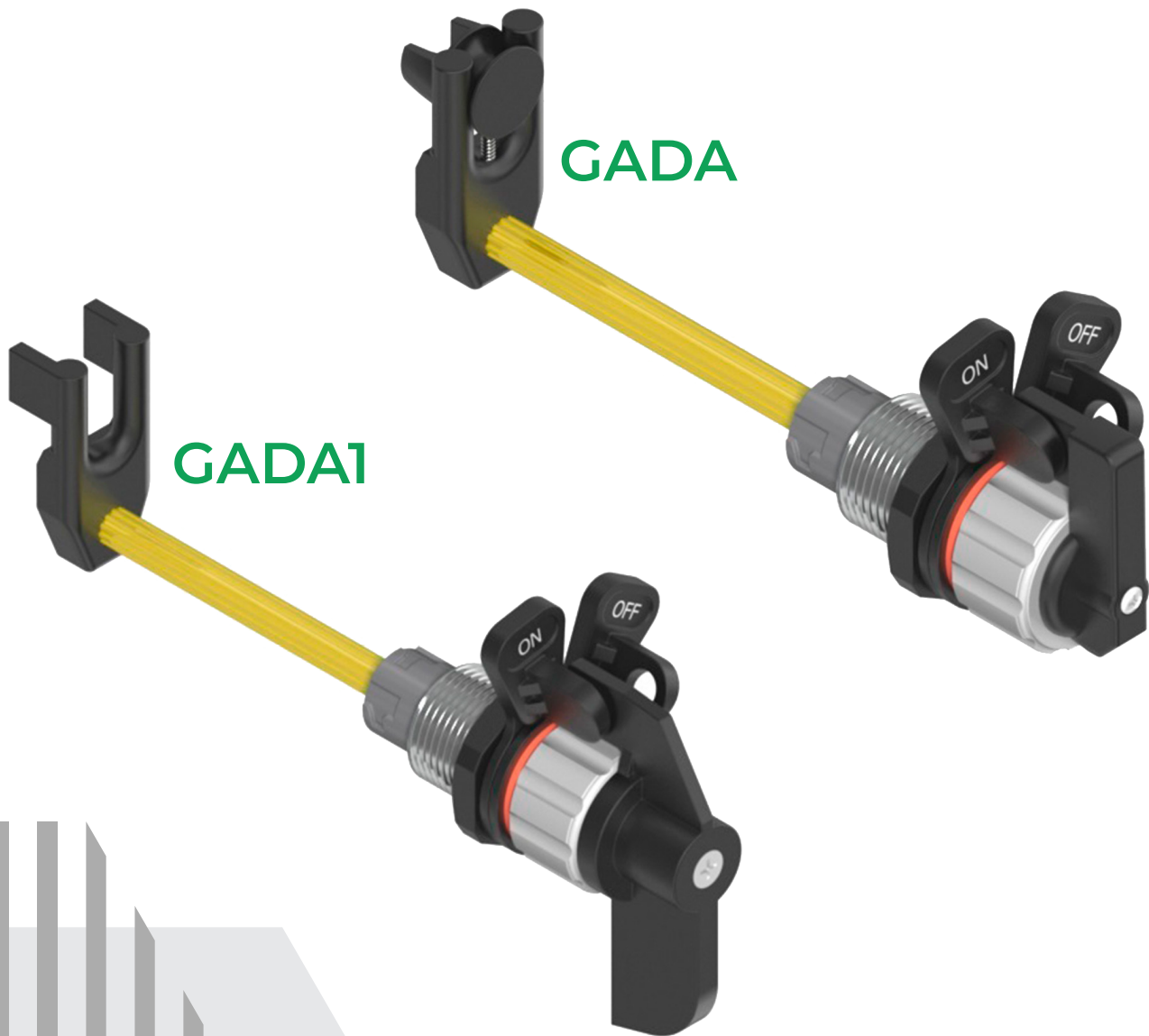





sermat **GRÜN**
ex

REV.25 / 05.03.2025

CIRCUIT BREAKER ACTUATOR - ADJUSTABLE

Technical Data

TECHNICAL SPECIFICATION

TYPE OF PROTECTION	Ex "d" – Flameproof Ex "t" – Dust ignition protection	Explosion proof Dust ignition proof	Ex "d" – Flameproof Ex "t" – Dust ignition protection
MARKING	Ex db IIC Gb Ex tb IIIC Db	Class I, Groups B, C, D Class II, Groups E, F, G Class III	II 2 G Ex db IIC / IIB +H ₂ Gb II 2 D Ex tb IIIC Db
AREA OF APPLICATION	Zone 1 Zone 2 Zone 21 Zone 22	Class I, Div 1 & 2, Groups B, C, D. Class II, Div 1 & 2, Groups E, F, G. Class III	Zone 1 Zone 2 Zone 21 Zone 22
INGRESS PROTECTION	IP66W (W: salt spray)	Type 4X	IP66
TEMPERATURE RANGE	-50°C to 60°C (-40°F to 158°F)	-50°C to 60°C (-40°F to 158°F)	-50°C to 100°C (-40°F to 212°F)
THREAD SIZE	M22 x 1,5 3/4" NPSM	M22 x 1,5 3/4" NPSM	M22 x 1,5 3/4" NPSM
THREAD LENGTH	25mm (Normal) 40mm (Long) 57mm (Extra Long)	25mm (Normal) 40mm (Long) 57mm (Extra Long)	25mm (Normal) 40mm (Long) 57mm (Extra Long)
INSTALLATION	for M22x1,5 THREAD	for M22x1,5 THREAD	for M22x1,5 THREAD
	in Ex "d"enclosures : (min. wall thickness : 8 mm engaged thread) in Ex "tb" enclosures : (min. wall thickness : 3 mm engaged thread)	in Ex "d"enclosures : (min. 6 fully engaged threads) in Ex "tb" enclosures : (min. 3 fully engaged threads)	in Ex "d"enclosures : (min. wall thickness : 8 mm engaged thread) in Ex "tb" enclosures : (min. wall thickness : 3 mm engaged thread)t
	for 3/4"NPSM THREAD	for 3/4"NPSM THREAD	for 3/4"NPSM THREAD
	in Ex "d"enclosures : (min. 5 fully engaged threads) in Ex "tb" enclosures : (min. wall thickness : 3,7 mm engaged thread)	in Ex "d"enclosures : (min. 7 fully engaged threads) in Ex "tb" enclosures : (min. 3 fully engaged threads)	in Ex "d"enclosures : (min. 5 fully engaged threads) in Ex "tb" enclosures : (min. wall thickness : 3,7 mm engaged thread)
CERTIFICATE OF COMPLIANCE	 OCP 0034		
	INMETRO	UL	 
	NCC 24.0128 U	UL: E489210	ATEX I IECEx UL 21 ATEX 2390U IECEx ULBR 21.0004U

CIRCUIT BREAKER ACTUATOR - ADJUSTABLE

Technical Data

DIMENSIONS

L	
mm	inch
100mm	≈ 3.15/16"
150mm	≈ 5.29/32"
200mm	≈ 7.7/8"

X	
mm	inch
25mm	≈ 1"
40mm	≈ 1.19/32"
57mm	≈ 2.1/4"

GADA

M22X1,5

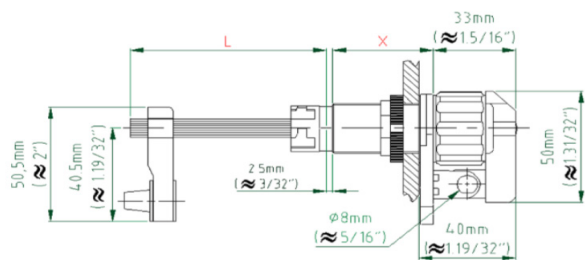

3/4" NPSM

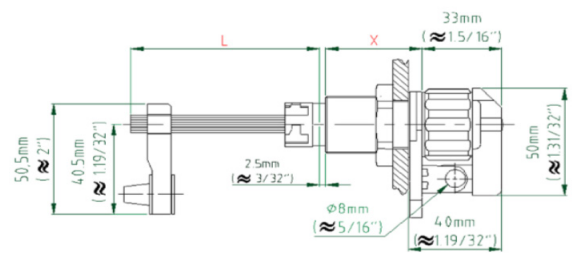

GADA I

M22X1,5

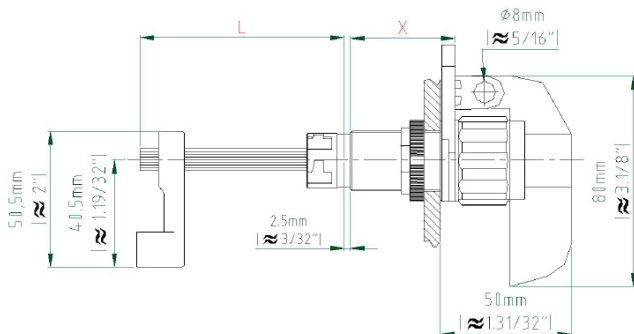

3/4" NPSM

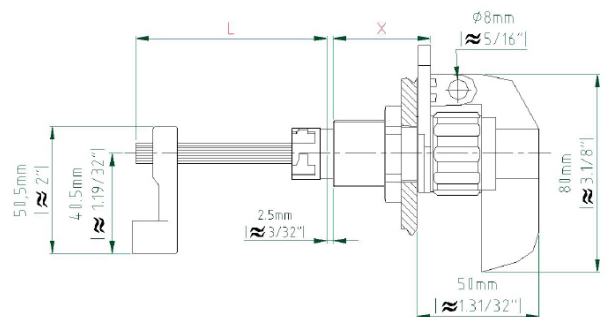

CIRCUIT BREAKER ACTUATOR - ADJUSTABLE

Ordering Code

ORDERING CODE

SGEXXGAD **A + B + C + D + E + F**

X

THREAD SIZE

size	M22x1,5	3/4"NPSM
code	22	26

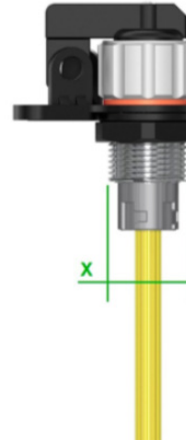

A

HANDLE LENGTH



	50mm	80mm
code	A	A1

B

THREAD LENGTH

length	25mm	40mm	57mm
code	N	L	X

C

AUTOMATIC RETURN



	CLOCKWISE	COUNTERCLOCKWISE
code	H	A

D

FORK MODEL



	SLIM WITH SLIDER	SLIM WITHOUT SLIDER	WITHOUT SLIDER	WITH SLIDER	FOR MOTOR BREAKER
code	CRS	SRS	SR	CR	MO

E

STAINLESS STEEL ROD LENGTH

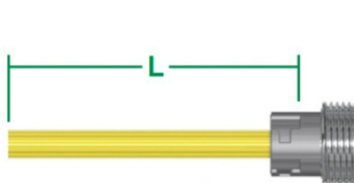

L	
code	size
100	100mm
150	150mm
200	200mm

F

EXTERNAL LIMITER FOR PADLOCK



	LIGA/DESLIGA	ON/OFF
code	B1	B2

APPLICATION:



Ideal for use in flameproof circuit breaker panel boards. Utilized for movement the breaker with an external rotary lever.



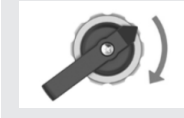
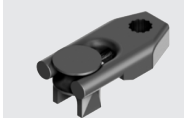

Easily adjustable by moving the fork on the brass rod. Spring return to center position. Handle available in two sizes: 50mm and 80mm.

CIRCUIT BREAKER ACTUATOR - ADJUSTABLE

Codification Examples

CODIFICATION EXAMPLES

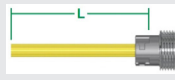
	+	3/4NPSM LENGTH 25MM	+		+		+		+	
SGEX26GADA		N		CLOCKWISE H		SLIM W/ SLIDER CRS		L=100mm 100		ON/OFF B2
=										
SGEX26GADANHCRS100B2										

	+	M22X1,5 LENGTH 25MM	+		+		+		+	
SGEX22GADA1		N		COUNTER CLOCKWISE A		SLIM WITHOUT SLIDER SRS		L=150mm 150		ON/OFF B2
=										
SGEX22GADA1NASRS150B2										