

PILOT LIGHT

GPL







sermat **GRÜN**
ex

REV.25 / 06.03.2025

PILOT LIGHT

Technical Data

TECHNICAL SPECIFICATION

TYPE OF PROTECTION	Ex "d" – Flameproof Ex "t" – Dust ignition protection	Explosion proof Dust ignition proof	Ex "d" – Flameproof Ex "t" – Dust ignition protection
MARKING	Ex db IIC Gb Ex tb IIIC Db	Class I, Groups B, C, D Class II, Groups E, F, G Class III	II 2 G Ex db IIC / IIB +H ₂ Gb II 2 D Ex tb IIIC Db
AREA OF APPLICATION	Zone 1 Zone 2 Zone 21 Zone 22	Class I, Div 1 & 2, Groups B, C, D. Class II, Div 1 & 2, Groups E, F, G. Class III	Zone 1 Zone 2 Zone 21 Zone 22
INGRESS PROTECTION	IP66W (W: salt spray)	Type 4X	IP66
TEMPERATURE RANGE	-50°C to 60°C (-40°F to 158°F)	-50°C to 60°C (-40°F to 158°F)	-50°C to 100°C (-40°F to 212°F)
THREAD SIZE	M22 x 1,5 3/4" NPSM	M22 x 1,5 3/4" NPSM	M22 x 1,5 3/4" NPSM
THREAD LENGTH	25mm (Normal) 40mm (Long) 57mm (Extra Long)	25mm (Normal) 40mm (Long) 57mm (Extra Long)	25mm (Normal) 40mm (Long) 57mm (Extra Long)
INSTALLATION	for M22x1,5 THREAD in Ex "d" enclosures : (min. wall thickness : 8 mm engaged thread) in Ex "tb" enclosures : (min. wall thickness : 3 mm engaged thread)	for M22x1,5 THREAD in Ex "d" enclosures : (min. 6 fully engaged threads) in Ex "tb" enclosures : (min. 3 fully engaged threads)	for M22x1,5 THREAD in Ex "d" enclosures : (min. wall thickness : 8 mm engaged thread) in Ex "tb" enclosures : (min. wall thickness : 3 mm engaged thread)
	for 3/4"NPSM THREAD in Ex "d" enclosures : (min. 5 fully engaged threads) in Ex "tb" enclosures : (min. wall thickness : 3,7 mm engaged thread)	for 3/4"NPSM THREAD in Ex "d" enclosures : (min. 7 fully engaged threads) in Ex "tb" enclosures : (min. 3 fully engaged threads)	for 3/4"NPSM THREAD in Ex "d" enclosures : (min. 5 fully engaged threads) in Ex "tb" enclosures : (min. wall thickness : 3,7 mm engaged thread)
CERTIFICATE OF COMPLIANCE	Segurança  OCP 0034  INMETRO	 UL LISTED	  IECEx
	INMETRO NCC 24.0128 U	UL UL: E489210	ATEX I IECEx UL 21 ATEX 2390U IECEx ULBR 21.0004U

PILOT LIGHT

Technical Data

ELECTRICAL INFORMATION

LED SOCKET

LED INFORMATION	
UTILITY LIFE	> 50.000 hours
RATED CORRENT	12mA
MAXIMUM POWER	1,5W



L001SG



LC240SG



LC480SG

ELECTRICAL SPECIFICATIONS FOR 12V / 24V / 120V / 220V

RATED VOLTAGE: 250 VAC/VDC
MAXIMUM POWER: 2,6W

ELECTRICAL SPECIFICATIONS FOR 240VAC

RATED VOLTAGE: 240 VAC
MAXIMUM POWER: 2,6W

ELECTRICAL SPECIFICATIONS FOR 480VAC

RATED VOLTAGE: 480 VAC
MAXIMUM POWER: 2,6W

DIMENSIONS

X	
mm	inch
25mm	≈ 1"
40mm	≈ 1.19/32"
57mm	≈ 2.1/4"

REGULAR LED SOCKET

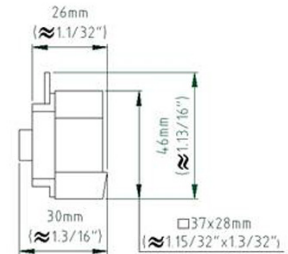

LED SOCKET LC240SG

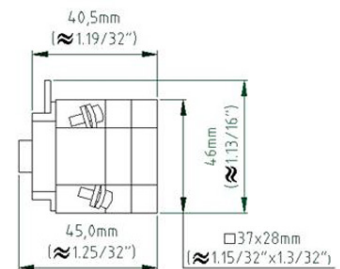

M22 X 1,5 PILOT LIGHT W/ REGULAR SOCKET LED FOR 12V / 24V / 120V / 220V

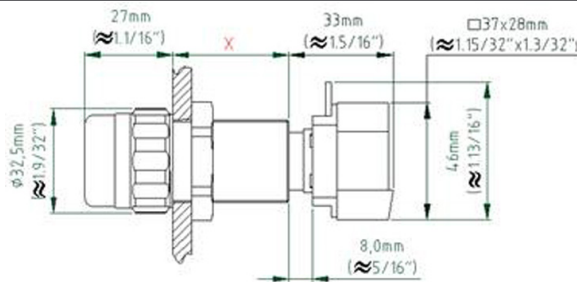

3/4" NPSM PILOT LIGHT LIGHT W/ REGULAR SOCKET LED FOR 12V / 24V / 120V / 220V

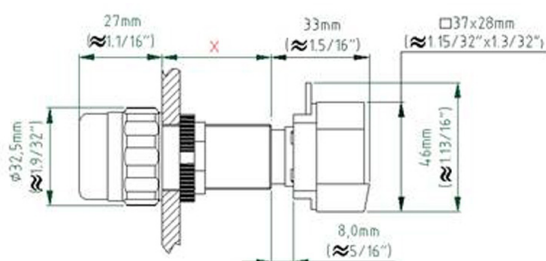

LED SOCKET LC480SG

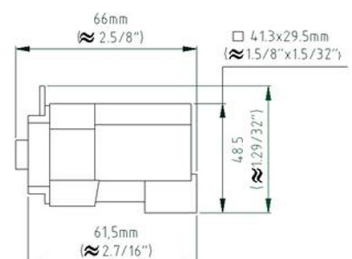

PILOT LIGHT





Ordering Code

ORDERING CODE

SGEXXGPL A + B + LED + C(C1+C2+C3+C4)

X THREAD SIZE		
size	M22x1,5	3/4"NPSM
code	22	26



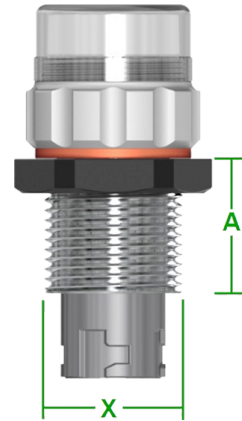

A THREAD LENGTH			
length	25mm	40mm	57mm
code	N	L	X

B COLOR					
					
color	Blue	Yellow	Red	Green	White
code	AZ	AM	VM	VD	IN



C LED = C1+C2+C3+C4	
---------------------	--

C1 LED LENGTH		
THREAD LENGTH	TYPE OF LED APPLIED	LED CODE
25 mm	LONG	L
40 mm	LONG	L
57 mm	EXTRA LONG	X

C2 LED COLOR					
					
COLOR	BLUE	YELLOW	RED	GREEN	WHITE
CODE	AZ	AM	VM	VD	BR

C3 LED VOLTAGE						
VOLTAGE	12 VAC/VDC	24 VAC/VDC	120 VAC/VDC	220 VAC/DC	240 VAC	480 VAC
CODE	01	02	03	04	.	.

SPECIAL CONFIGURATIONS ONLY FOR PILOT LIGHT

C4 WORKING STATUS		
STATUS	CONTINUOUS	FLASHER
CODE	-	PP

The version of the flasher LED for 220/240 Vac voltage is only possible using the LC240SG voltage divider block + 120 V flasher LED.

LED SPECIAL CONFIGURATION

240 VAC VOLTAGE DIVIDER		480 VAC VOLTAGE DIVIDER	
CODE	LC240SG	CODE	LC480SG

LED SIZE	LED		LED SIZE	LED	
	LONG	L		LONG	L
EXTRA LONG	X	EXTRA LONG	X		

LED COLOR	BLUE	AZ	LED COLOR	BLUE	AZ
	YELLOW	AM		YELLOW	AM
	RED	VM		RED	VM
	GREEN	VD		GREEN	VD
	WHITE	BR		WHITE	BR

LED VOLTAGE	120VAC/VDC	03	LED VOLTAGE	120VAC/VDC	03
-------------	------------	----	-------------	------------	----

STATUS	CONTINUOUS	-	STATUS	CONTINUOUS	-
	FLASHER	PP		FLASHER	PP







NOTE: The LEDs are sold separately. For more LED information, please consult the LED datasheet.

PILOT LIGHT

Codification Examples

CODIFICATION EXAMPLES

FOR LED REGULAR CONFIGURATION

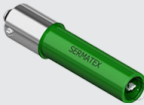
 SGEX26GPL	+	3/4NPSM LENGTH 25MM N	+	 VM	+	 REGULAR LED SOCKET	+	 12V LEDLVM01PP	=	PILOT LIGHT REGULAR CONFIGURATION FOR 12V SGEX26GPLNVM + LEDLVM01PP
 SGEX22GPL	+	M22X1,5 LENGTH 25MM N	+	 VD	+	 REGULAR LES SOCKET	+	 24V LEDLVD02	=	PILOT LIGHT REGULAR CONFIGURATION FOR 24V SGEX22GPLNVD + LEDLVD02

FOR LED SPECIAL CONFIGURATION

 SGEX26GPL	+	3/4NPSM LENGTH 25MM N	+	 VM	+	 VOLTAGE DIVIDER LC240SG	+	 120V LEDLVM03	=	PILOT LIGHT SPECIAL CONFIGURATION FOR 240V SGEX26GPLNVM240 + LEDLVM03
 SGEX22GPL	+	M22X1,5 LENGTH 25MM N	+	 VD	+	 VOLTAGE DIVIDER LC480SG	+	 120V LEDLVD03PP	=	PILOT LIGHT SPECIAL CONFIGURATION FOR 480V SGEX22GPLNVD480 + LEDLVD03PP

IDENTIFICATION PLATE (only for M22x1,5 thread)

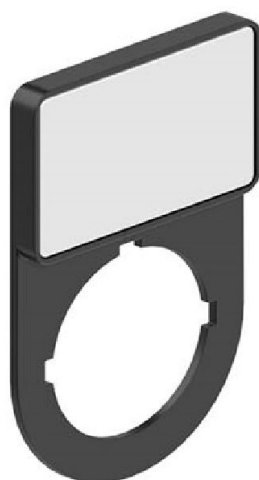

CODE	S2PL1	
------	-------	--

PRINTABLE AREA	10x25 mm
----------------	----------

G00	LIGA	G05	STOP
G01	DESLIGA	G06	RESET
G02	ABRE	G07	OPEN
G03	FECHA	G08	CLOSE
G04	START	G09	

DIMENSIONS(mm)

